

Wheel Features

Tread Material:	Nylon	Core Material:	Nylon
Bearing:	Single Ball Bearing	Tread Hardness:	75D±3
Temperature:	-30°C~90°C	Running Speed:	3.2km/h

Note: Use beyond temperature range or beyond the recommended speed may shorten product life or even damage the product.







- ✔ Precision 304 stainless steel bearing, rust-proof, flexible rotation
- ✔ Injection nylon, high load capacity, high wear resistance
- ✔ No deformation, anti-aging, endurable to humid environment
- ✔ With plastic covers, thread-proof design
- ⚠ Hard wheel material, it may cause indentations on floor
- ⚠ Wheel running may cause some noise

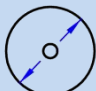
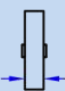

Rolling resistance	■ ■ ■ ■ ■	Excellent
Wear resistance	■ ■ ■ ■ ■	Excellent
Operating noise	■ ■ □ □ □	Acceptable
Floor surface preservation	■ ■ □ □ □	Acceptable

Bracket Features

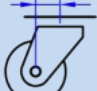
- ✔ Easy to operate, convenient to release the brake
- ✔ 304 Stainless Steel material pressed, anti-rust and anti-corrosion
- ✔ Polishing treatment, excellent appearance

Parameter (mm)							
Wheel Size	Capacity	Wheel Dia.	Wheel Width	Total Height	Offset	Swivel Radius	Swivel Radius
1.5"	30 kg	40	20	60	25	45	67
2"	50 kg	50	22	70	23	48	67

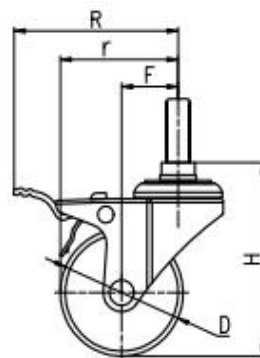
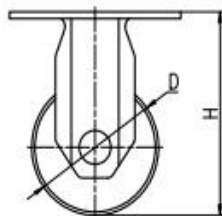
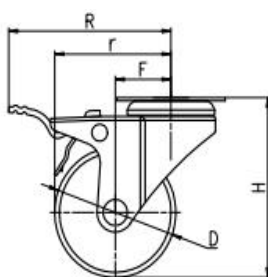

[English]

Mounting Drawing

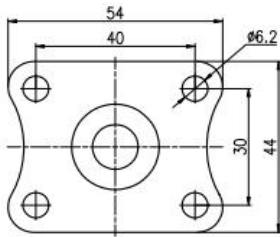

Plate Swivel/Brake

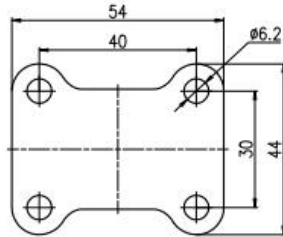
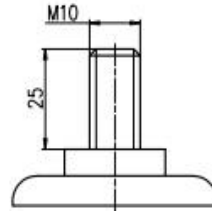







Plate Fixed



Threaded Stem

Product ID					
Wheel Size	Plate swivel	Plate fixed	Plate swivel brake	Threaded stem	Threaded stem brake
1.5"	10D01-1629	10D02-1629	10D03-1629	10D04-1629	10D05-1629
2"	10D06-1630	10D07-1630	10D08-1630	10D09-1630	10D10-1630

Product Details



Electrolytic polishing, appearance is beautiful and simple.

Concave and convex dustproof cover, anti-winding.



Double steel bowl design, stable structure, flexible rotation.

